

## Building our Community since 1970

Welcome to Shuswap Lake Estates... *Live your Best Life*

Overlooking Sparkling Shuswap Lake - Golf, Swimming, Cycling, Boating, Fishing and Hiking are just a few activities at your doorstep.

We are all living differently in today's world and many of us are looking to change the way we live. Upsizing, downsizing, working from home, new opportunities, finding your passion, more family time. The reasons may be different, but it's truly about the simple things in life; enjoying new experiences, creating memories and living your best life. For over 50 years, Shuswap Lake Estates has been building a community that offers you the kind of lifestyle you've been dreaming of. We have developed over 840 acres of land since 1970 and have over 730 acres remaining. Most of the land has been developed into single family properties where a purchaser may choose a vacant lot and build a home to fit their lifestyle. It's not hard to adjust to the Shuswap Lifestyle. A lively community center with an abundance of scheduled activities. Learn



how to line dance, join pickle ball, tennis or golf, spend an afternoon with one of the card groups, or build your own model airplane and join the fun with the Shuswap Aero Modelers. The Highlands sits above the bay and features panoramic views of Shuswap Lake, the golf course and Tappen Valley. The community offers premium, fully serviced lots on which to build that dream home. Head out your backyard to meander the 4 km's of walking and hiking trails throughout the peaceful and friendly neighbourhood.

It's no surprise then that this way of life is not hard to get used to.

After finding the ideal neighbourhood and property, move away from hectic city life and start living your best life in cottage country. With an international airport in Kelowna, or a domestic airport in Kamloops, visiting friends, family or new destinations around the world is only a short drive away.

Phase 3 of the Highlands will be available for pre-sales early spring 2025, stop by for a visit and choose your property. This is your time to plan and design a home that fits your needs and wants.

Shuswap Lake Estates and Highlands phase 3 is located in Blind Bay, between Kamloops and Salmon Arm, from starter homes to dream homes, for young families to retirees, our housing developments have something for everyone.

With Choices for Everyone... *Live your Best Life*...at Shuswap Lake Estates,



*Autumn Ridge*

### Under Construction... Ready for a Spring Move-in

Lot 30 & Lot 31 2715 Golf Course Drive. Bare Land Strata, you own your home and property and share the expense of the common areas.

Strata fee is only \$87.00 per month and let the Strata take care of your snow plowing and front yard maintenance.

Level entry 2 bedroom, 2 full bathrooms, open design, back covered patio, double garage 1324 sq feet of living space and a 6 foot concrete crawl space for storage.

Air conditioned, heat recovery ventilation, located across from the golf course, a few minutes drive to groceries, shopping and fine dining. Call Lois at the office 250 675 2523

Quality building by Hobart Construction.



# Shuswap Lake Estates

Box 150 Blind Bay BC V0E 1H0  
250 675 2523

November, December & January 2025  
sales@shuswaplakeestates.com

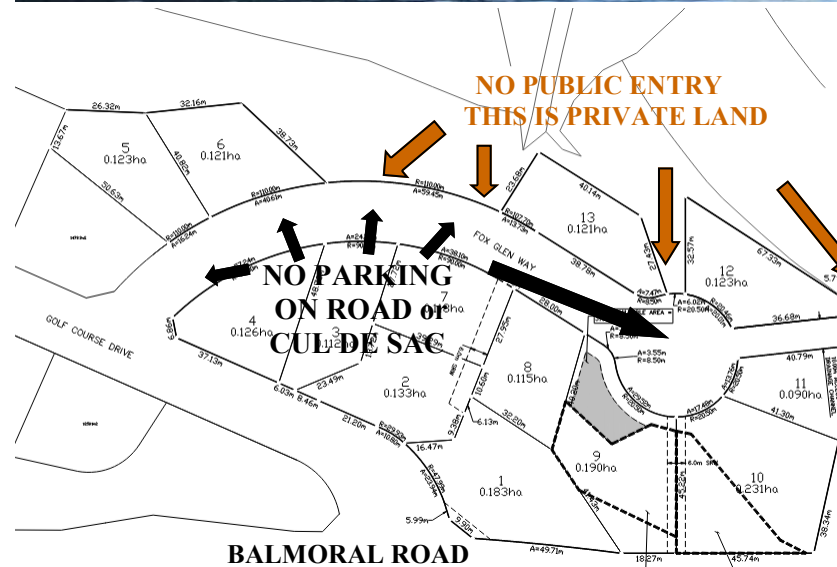

### Fox Glen Way

The residents of Fox Glen Way have moved here to Shuswap Lake Estates to enjoy this quiet peaceful setting. Shuswap Lake Estates has never before had a problem with pick-up truck, quads and ATV's ripping through the lagoon area until this past summer and the latest happened on Oct. 26 when one of the neighbours went out in the dark to find a pick up stuck in the mud behind her home. The police were called and it turned out to be a stolen truck with stolen plates. An ATV was also with them. Another problem is with residents walking through private property, their dogs pooping on their yards, people peering in their windows and basically violating their privacy. From this time on, there will be "No Entry" to any walking trails that are adjacent to any of these properties. Please have some respect for your surroundings when enjoying a walk on the trails.

### Good Time Quilter's

Come and join the Good Time Quilter's at Shuswap Lake Estates Community Center. Every first and third Tuesday of the month 9:30 am—3 pm from September until May. Contact Stephanie 250 675 4936 or 250 803 1625



**River of Life Community Church**  
**OPERATION CHRISTMAS CHILD**  
**Shoebox Packing Party**  
**November 15th 4:30—10:00 pm**  
**Shuswap Lake Estates**  
**Large Banquet Room**

**River of Life**  
**Community Church**  
**Christmas Party**  
**December 14th**  
**Call For Info**  
**Sandi 250 803 8838**

### Property Fire Smart Rebate

In the May newsletter, Shuswap Lake Estates offered an additional \$500.00 rebate to the first 20 households who qualified for the CSRD Fire Smart Program. The CSRD Fire Smart Program was to help out with the cost of clearing debris and flammables from around the outside of the home. To get through all of the CSRD paperwork and inspections was quite a lengthy procedure. We only had 4 households who sent us their applications. Out of these 4 only one has received their rebate from the CSRD and we proudly gave them the additional \$500.00 from our office. Gord, Celine, Mya, Peanut & Epi came to the office to collect their rebate cheque from Cory Barker at Shuswap Lake Estates.



Blind Bay Businesses email to have your business added sales@shuswaplakeestates.com			
A & B Plumbing	Plumbing & Repairs	Brent	604 760 2041
Avon Canada	Avon Products in Blind Bay	Mona	604 970 6078
Blindspot Audio Production	Audio Engineering, Recording, Sound Mixing, Video's	Steve	403 617 4500
Blind Bay Billy	Red Seal Residential & Commercial Painter	Bill	604 831 3179
Brian O'Keefe Golf Services	Club Repair, Regripping & Fitting, Golf Lessons,	Brian	778 220 2863
Bryn Drafting & Design	Drafting, Design & Energy Modeling	Sue	250 863 7664
Century 21 Lakeside Realty	Home & Property Sales & Listings	Kevin	250 833 8965
Chalk Couture	High End DIY Home Decor	Christine	250 571 7418
Cork N Cap U-Brew	Wine making supplies and U-Vin Shop	Kirsten	250 675 3400
Dominion Lending Mortgages	Mortgage Broker	Bobbi-Lee	250 517 7019
K.L.S. Projects	Custom Home Builder & Renovations	Brian	604 970 8242
Lavish Lashes	Eyelash Extensions	Brandy	250 463 1980
Little River Framing Studio	Custom Picture Framing	Ruth	250 675 5469
Shuswap Concierge	Auto & Boat Detail, Snow Removal, House Watch	Colin	250 253 2491
Triebel Jewelry	Jewelry Repairs	Roland	778 256 1017
Ridgeback Earthworks	Landscaping Excavating, Equipment Rentals	Jory	250 253 8473
Royal Lepage Access Realty	Home & Property Sales & Listings	Jeff	250 253 7991
Shantz Real Estate	Home & Property Sales & Listings	Caroline	250 517 0391
Build It	General Construction, Framing, Exterior Renovations	Beau	250 463 1538
Spinnaker Café'	Breakfast, Brunch & Thurs, Fri, Sat Italian Evening	Kirsten	250 675 2238
SJO Renovations	Home Renovations & Repairs	Mark	250 675 3820
Taleen Pileggi Photography	Professional Photographer	Taleen	416 677 7310
Torrez.ca Creative	Graphic Designer, Illustrator, Pyrographer	Cori	780 803 9914
Rancher's Pizza & Bar	Restaurant, Pizza & Beer	Call	1 778 490 0066
Timber	Fine Dining, Breakfast, Lunch & Dinner	Call	1 778 490 5051

**ARNOLD BAYER**  
 DRAFTING AND DESIGNING  
 NEW HOMES  
 AND  
 RENOVATIONS  
 Phone 604-989-9587  
 Email arnoldbayer@telus.net



**Water or Sewer Emergencies**  
**Erik 1 250 463 1910**  
**Aron 1 403 618 6632**

**Guided Meditation**  
**Gathering Circle for mindfulness.**  
 Join us every Thursday from 3:00-4:30.  
 Shuswap Lake Estates Community Center.  
 Everyone is welcome. By donation.  
 Email: Patty at  
[MeditationGathering1234@gmail.com](mailto:MeditationGathering1234@gmail.com)  
 for more information.

Email me your family favorite Christmas Recipe to sales@shuswaplakeestates.com I can put them up on the web site for everyone to enjoy.

**Sorrento Lions Club**  
**Community Christmas Party**  
**November 23rd at**  
**Shuswap Lake Estates Community Center**  
**For more information call Judy at 250 675 2616**

**Shuswap Lake Golf Course**

What a season it has been at the Shuswap Lake Golf Course! As the golf season comes to an end and we reflect back on 2024, there is a lot to be proud of as well as to learn from. With GolfNorth stepping in as the new management company we saw plenty of changes including new leadership at every level and in every department, and a new philosophy take place with the focus on growing this facility to it's full potential, and providing place our members can call home. New Golf Course Superintendent Patricia Sloan has stepped into her role with passion and devotion, and her efforts presented a golf course that was consistently in the best shape it has ever been. The feedback from members and guests alike has been overwhelmingly positive, and we are fortunate to have such a dedicated professional on our team. The refocus of our front-line staff in every department on the importance of building relationships within our community has also spread throughout the facility, and it has gone a long way into transforming the culture and environment in which we all work and play. As we look towards the future of operations here at The Shuswap Lake Golf Course and Duffer's Grill & Lounge, we are excited for the winter and the opportunity to plan for 2025. You will see more events for members & public alike, the enthusiasm of everyone you engage with here on the property, and more opportunities to make memories with the ones you care about. Thank you to everyone who came out and supported us this past season, though this is only the beginning. We can't wait to show you what's to come!  
 Walt McIlhone *PGA of Canada "Class A" Golf Professional* General Manager  
 TPI Certified Academy Instructor & Coach, Certified Personal Trainer 250.675.2315 [golfnorth.ca/shuswaplake](http://golfnorth.ca/shuswaplake)

**Bear Aware**

During the fall, bears start consuming more calories to pack on fat reserves for the winter. Adult bears need to consume approximately 20,000 calories per day during the fall, meaning they are more active while in search of food. If given the opportunity, bears will take advantage of easy meals from things like unsecured trash cans and bird feeders. If bears don't find a food source in a neighbourhood, they will move on. Secure your garbage containers, never leave pet food outdoors, remove or secure bird feeders, clean and store grills.

**A ROARING 20'S THEMED**  
*New Years*  
**PARTY**  
 when  
**Tuesday, December 31st**  
 where  
**Shuswap Lake Estates**

**Tickets \$75.00** Three Course Dinner  
 Dance: Serious Dogs  
 Cash Bar 150/50 Draw  
 Prizes | Signature Drink on Arrival

Call Karen for information 250 515 3276



**The Holiday's 2024**  
 The Shuswap Lake Estates Christmas Light Up Contest is upon us once again. Fall is the perfect time to start decorating your home for the holiday season. Last year Shuswap Lake Estates was lit up from the bay to the top of the Highlands and it looked festive and magical. Judging will take place the middle of December and prizes will be mailed out in January.