

Shuswap Lake ESTATES

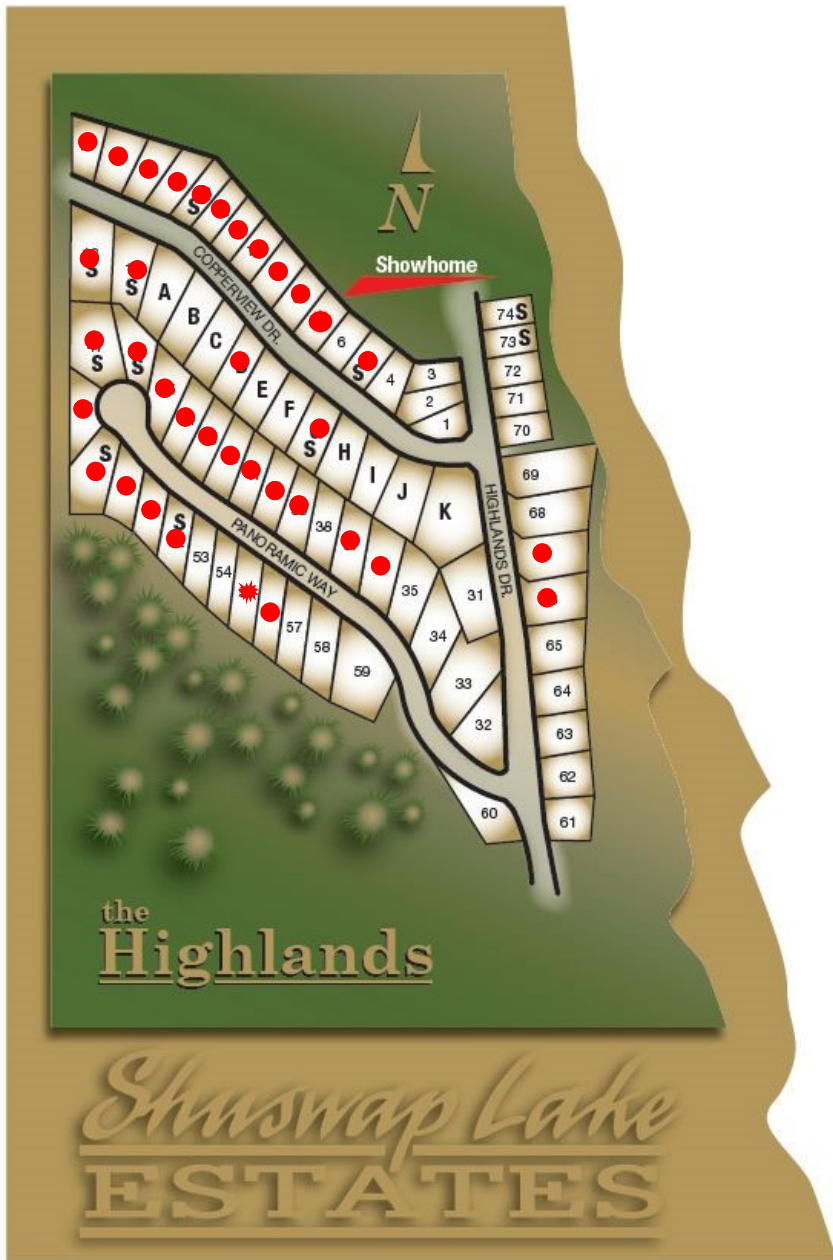

1	.29 acre	\$ 154,000.00	38	0.27 acre	\$ 194,000.00
2	0.33 acre	\$ 159,000.00	39	SOLD	SOLD
3	0.31	\$ 119,000.00	40	SOLD	SOLD
4	0.4	\$ 189,000.00	41	SOLD	SOLD
5	SOLD	SOLD	42	SOLD	SOLD
6	0.28	\$ 194,000.00	43	SOLD	SOLD
7	SOLD	SOLD	44	SOLD	SOLD
8	Showhome	SOLD	45	SOLD	SOLD
9	0.28	SOLD	46	SOLD	SOLD
10	SOLD	SOLD	47	SOLD	SOLD
11	SOLD	SOLD	48	SOLD	SOLD
12	SOLD	SOLD	49	SOLD	SOLD
13	SOLD	SOLD	50	SOLD	SOLD
14	SOLD	SOLD	51	SOLD	SOLD
15	SOLD	SOLD	52	SOLD	SOLD
16	SOLD	SOLD	53	0.27	\$ 129,000.00
17	SOLD	SOLD	54	0.27	\$ 129,000.00
18	SOLD	SOLD	55	Showhome	\$ 589,000.00
19	SOLD	SOLD	56	SOLD	SOLD
A	0.42	\$122,000.00	57	0.29	\$ 124,000.00
B	0.39	\$122,000.00	58	0.29	\$ 124,000.00
C	0.36	\$124,000.00	59	0.38	\$ 129,000.00
D	SOLD	SOLD	60	0.43	\$ 149,000.00
E	0.32	\$124,000.00	61	0.34	N/A
F	0.31	\$124,000.00	62	0.29	N/A
G	SOLD	SOLD	63	0.32	N/A
H	0.3	\$124,000.00	64	0.33	N/A
I	0.28	\$124,000.00	65	0.33	\$ 179,000.00
J	0.29	\$124,000.00	66	SOLD	SOLD
K	0.43	\$ 154,000.00	67	SOLD	SOLD
31	0.28	\$ 134,000.00	68	0.43	\$ 149,000.00
32	0.31	\$ 169,000.00	69	0.46	\$ 149,000.00
33	0.29	\$ 189,000.00	70	0.33	\$ 153,000.00
34	0.28	\$ 189,000.00	71	0.27	\$ 139,000.00
35	0.27	\$ 194,000.00	72	0.27	\$ 139,000.00
36	SOLD	SOLD	73	SOLD	SOLD
37	SOLD	SOLD	74	SOLD	SOLD

All measurements are approximate
Prices may change without notice

AUG 2018

55 0.30 Showhome \$589,000